

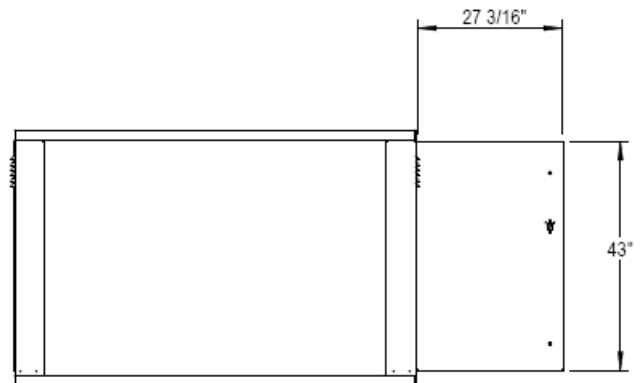

DISTRIBUTED BY HANNAN SPECIALTIES, INC.
 4019 LEOS LANE UNIT #3
 CARMICHAEL, CA 95608
 (800)722-2453 or (916)488-7026
 fax (916)488-7256
 www.duralocker.com

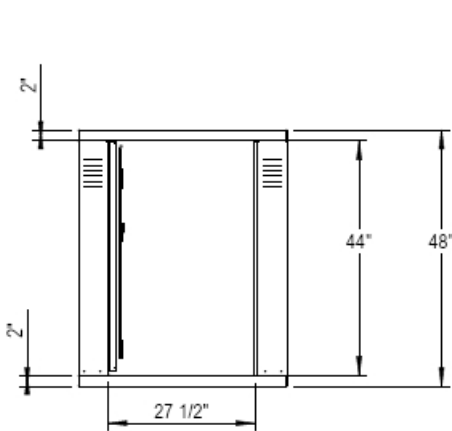
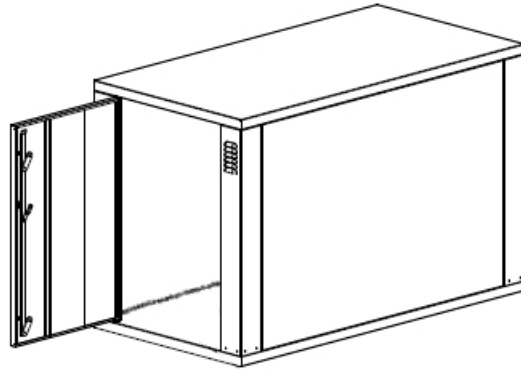
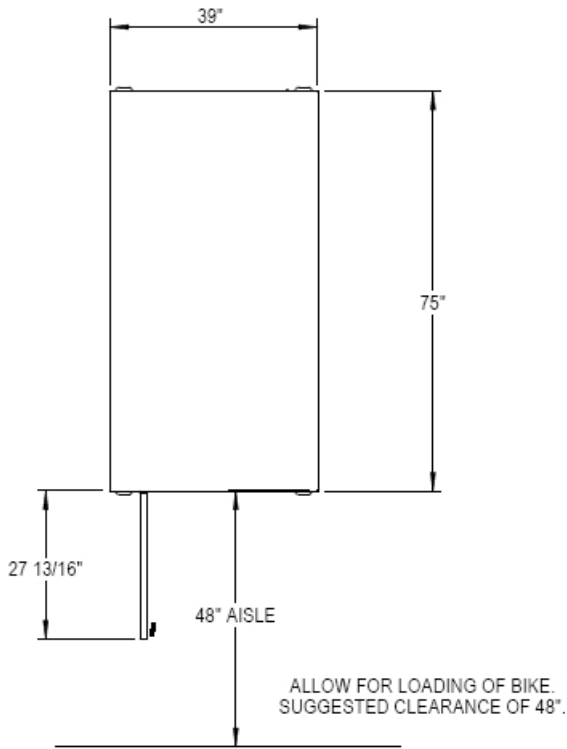

PRODUCT: DL100-1(F)
 DESCRIPTION: DURA LOCKER® BIKE LOCKER
 1 UNIT - 1 DOOR, 1BIKE CAPACITY. POP OUT 'T' LOCKS.
 WITH FLOOR

DATE: 6-16-04
 ENG: JRH

NOTES:

1. INSTALL BIKE LOCKERS ACCORDING TO MANUFACTURER'S SPECIFICATIONS.
2. CONSULTANT TO SELECT COLOR(FINISH), SEE MANUFACTURER'S SPECIFICATIONS.
3. SEE SITE PLAN FOR LOCATION OR CONSULT OWNER.

CONFIDENTIAL DRAWING AND INFORMATION IS NOT TO BE COPIED
 OR DISCLOSED TO OTHERS WITHOUT THE CONSENT OF HANNAN SPECIALTIES, INC.
 SPECIFICATIONS ARE SUBJECT TO CHANGE WITHOUT NOTICE.